



Paddockhall Road, Haywards Heath
£275,000 Share of Freehold



23 Kipling Court Paddockhall Road, Haywards Heath, RH16 1EX

£275,000 Share of Freehold

- **Prime Location:** Situated within the gated Winnals Park development in Haywards Heath.
- **Bright Lounge:** Spacious and inviting living area with ample natural light.
- **Refitted Kitchen:** Smartly designed with a built-in stainless steel oven, hob, and extractor.
- **Gas Central Heating:** Efficient heating system complemented by double-glazed windows.
- **Additional Storage:** Dedicated bike and bin storage facilities included.
- **3rd-Floor Apartment:** Modernized and serviced by a lift for easy access to all floors.
- **Two Double Bedrooms:** Generously sized, ideal for comfort or versatility.
- **Modern Bathroom:** Fully tiled with contemporary fittings.
- **Parking & Garage:** Ample residents' parking and a private garage in a separate block.
- **Commuter-Friendly:** Short walk to Haywards Heath station, with excellent rail links to London and Brighton.

Located within the gated Winnals Park development, this modernized 3rd-floor apartment in Kipling Court offers stylish and convenient living in a highly sought-after location in Haywards Heath.

The property boasts a bright and welcoming lounge, two generously sized double bedrooms, and a fully tiled bathroom. The kitchen has been smartly refitted, featuring a built-in stainless steel oven, matching hob, and extractor. With gas central heating and double-glazed windows throughout, the apartment provides a comfortable and energy-efficient living environment.

Additional features include ample residents' parking, a private garage in a separate block, and access to bike and bin storage facilities. A lift services all floors, ensuring ease of access.

Conveniently located just a short walk from Haywards Heath station, this apartment is a commuter's dream, offering excellent rail links to London, Brighton, and other major destinations. Nestled within a secure and well-maintained gated community, Kipling Court offers the perfect blend of modern living and a prime location, making it an ideal choice for professionals, couples, or investors.



Floor Plans

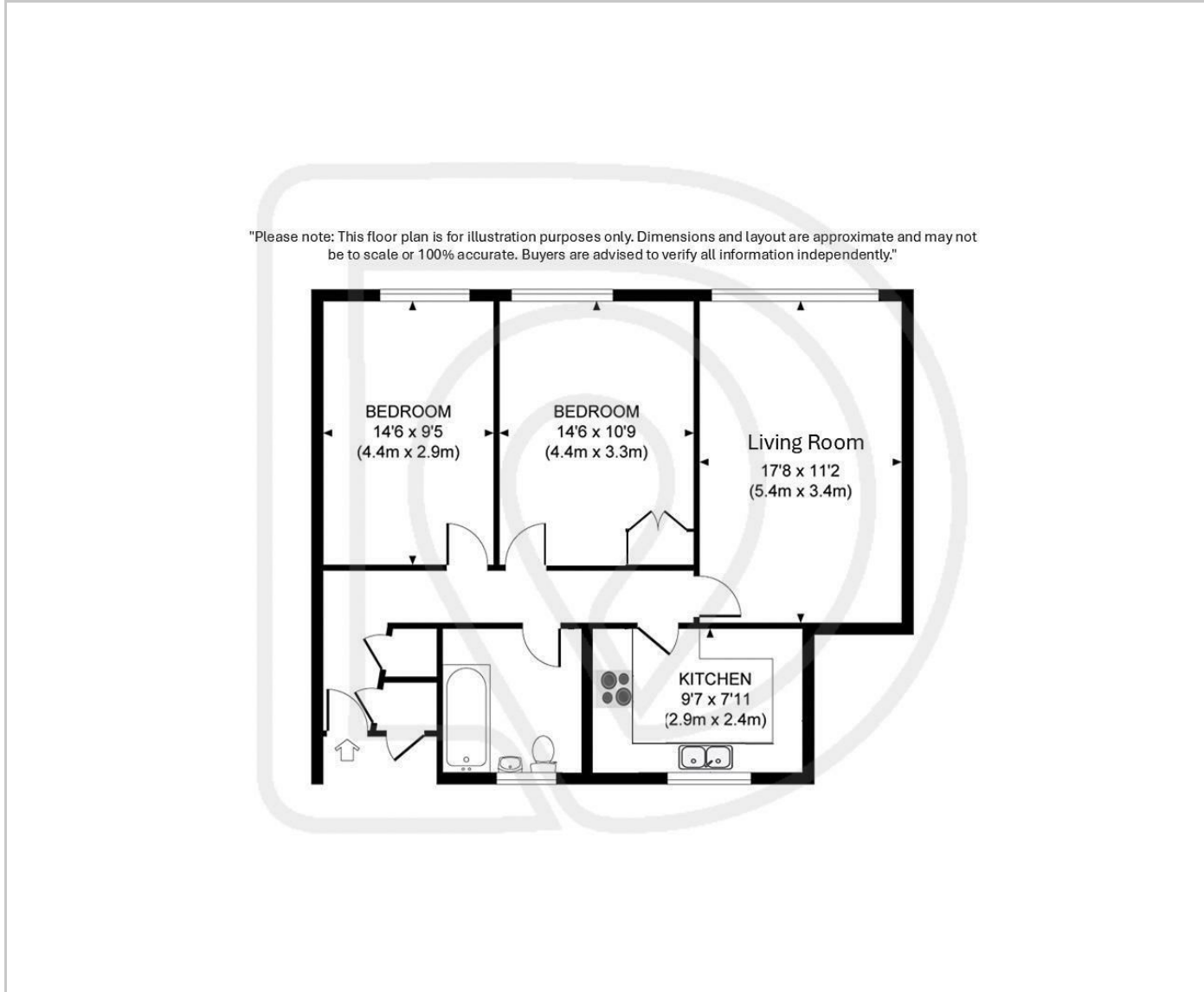

Area Map

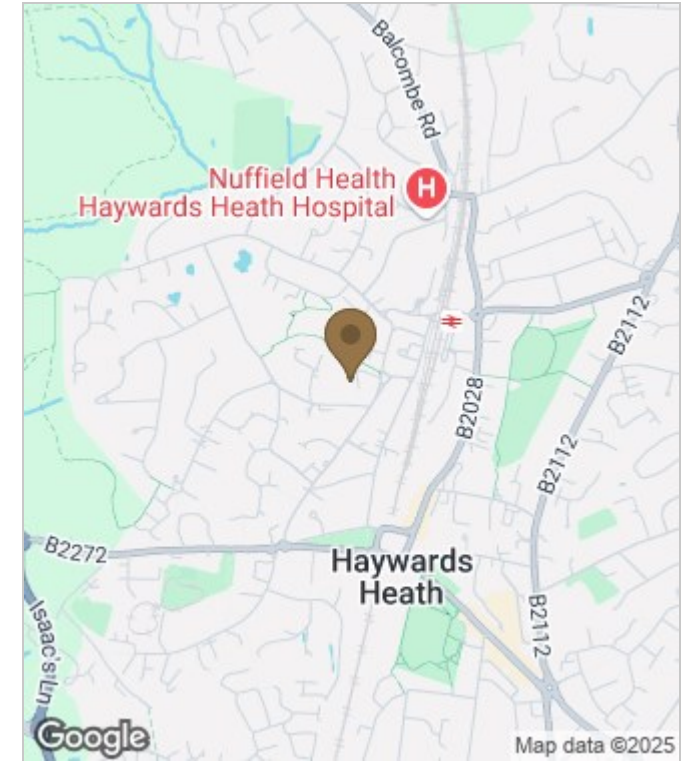

Energy Performance Graph

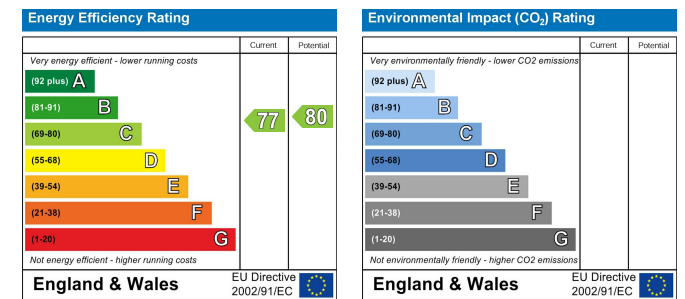

These particulars, whilst believed to be accurate are set out as a general outline only for guidance and do not constitute any part of an offer or contract. Intending purchasers should not rely on them as statements of representation of fact, but must satisfy themselves by inspection or otherwise as to their accuracy. No person in this firm's employment has the authority to make or give any representation or warranty in respect of the property.